

TTTO

EVALUATION MANUAL

*SHORT VERSION OF OWNERS MANUAL
FOR EVALUATION PURPOSES*





WELCOME TO ATTO

DO NOT USE THIS DOCUMENT AS OWNER'S MANUAL

WELCOME!

This is a short version of ATTO user manual and intended for potential users who are interested to evaluate how ATTO is used and what is required from them in order to use ATTO.

The Table of content on the following page is showing real content and number of pages of the full Owner's manual provided in hardcopy to ATTO users.

THIS DOCUMENT LACK MOST SAFETY AND REGULATORY PARTS OF THE ORIGINAL OWNER'S MANUAL.

Please contact us with any question and we will be happy to assist you.

Use the following link to speak with product specialist:

www.movinglife.com/call-invite

TABLE OF CONTENT

| | |
|---------------------------|----|
| PREFACE | 7 |
| ABOUT THIS MANUAL | 9 |
| BACKGROUND | 12 |
| SAFETY | 14 |
| ATTONOMY | 28 |
| OPERATING ATTO | 31 |
| TRANSPORTING ATTO | 65 |
| TROUBLESHOOTING | 66 |
| MAINTENANCE | 68 |
| SPECIFICATIONS..... | 74 |
| LIMITED WARRANTY..... | 78 |
| CONTACT INFORMATION | 80 |

PREFACE

Trademarks

ATTO is a registered trademarks of Moving Life Ltd.

Other company and brand, product and service names are for identification purposes only and may be trademarks or registered trademarks of their respective holders. Data is subject to change without notice.

This product is covered by Moving Life Ltd. patents pending.

Indications for Use

The Moving Life ATTO Mobility Scooter is an indoor scooter that provides transportation for a disabled or elderly person.

Intended Users

A motorized three-wheeled vehicle is a battery-powered device intended for medical purposes that is used for outside transportation by disabled persons.

ATTO is intended for people with an injury, physical disability, or medical condition which means that they are unable to walk or have difficulty in walking.

Intended users should assess eyesight, reaction time, balance and posture, ability to sit for long periods of time, concentration and ability to get on and off the mobility scooter. Intended users should be able to judge distances, recognize obstacles and hazards, and be able to see pedestrians and other road users.

The intended user of ATTO is the occupant who will be driving it and who may be assisted by an assistant for non-driving operations such as opening and closing the mobility scooter.

ATTONOMY



DO NOT USE THIS DOCUMENT AS OWNER'S MANUAL

Figure 1 ATTO in trolley mode

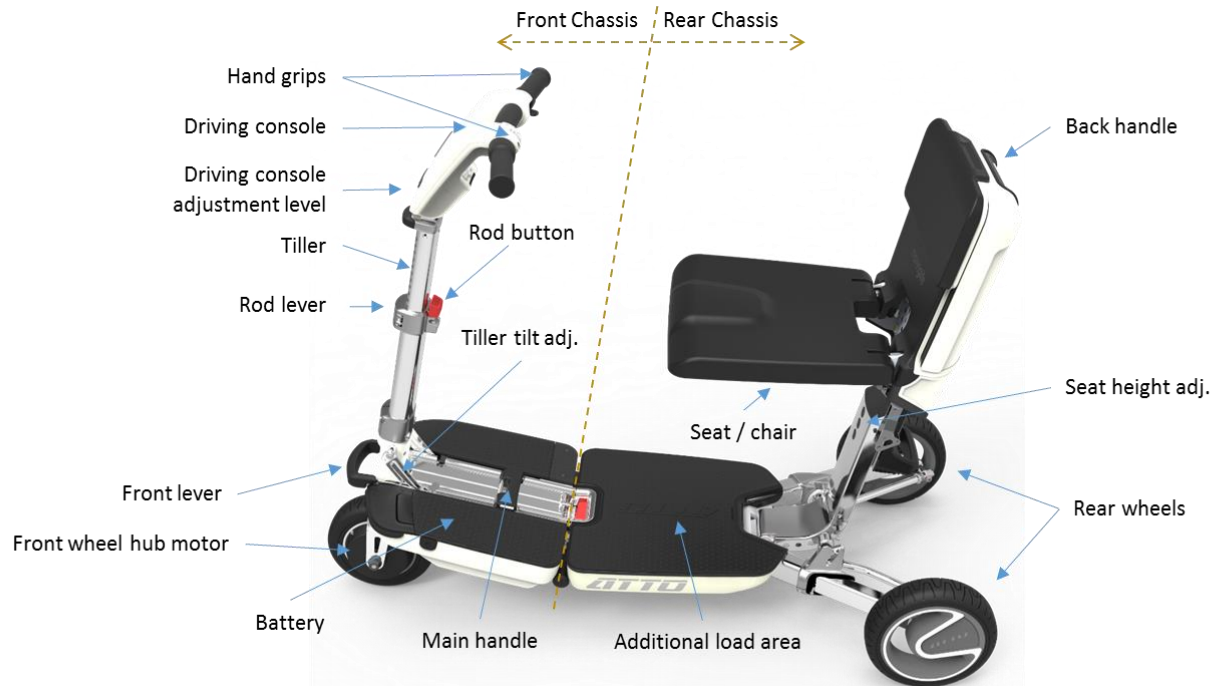

Figure 2 ATTO in driving mode

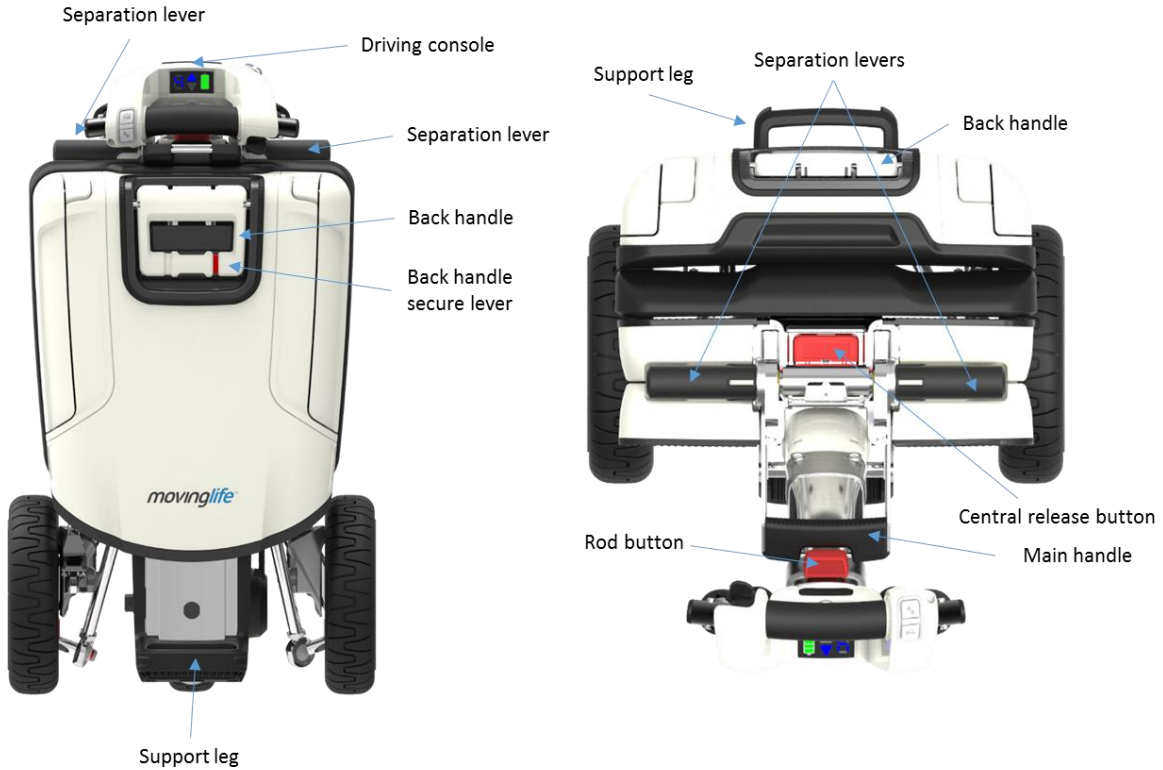

Figure 3 – More ATTO parts

OPERATING ATTO

ATTO is very easy to operate; it requires no special skills and can be learned by following the steps described in the following pages and by practice.

The first step is reading through this chapter of the Owner's Manual and understanding the sequence of steps required for opening and closing (folding) the scooter. Once completed, use the manual to guide you while you practice each step. It may be difficult at first but will be very easy once you have practice it several times.

To help you learn we have created a simple video you can watch under the videos section of our website:

www.movinglife.com/videos

Opening

1. Make sure your ATTO is on flat ground before opening. Make sure you have clearance of 2 meters (7 feet) from the side of the back wheels.
2. Release the adjustment lever of the handle bar and bring the handle bar to an upright position, then bring the lever back to its secured position (see Figure 4).



Figure 4

3. Press the central release button until it clicks and remains pressed (see Figure 5).



Figure 5

4. Press the rod button and tilt it away from the main ATTO body (see Figure 6).

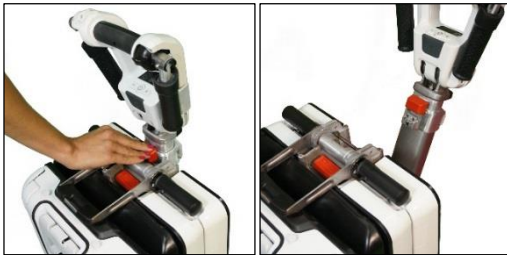

Figure 6

5. Hold ATTO with two hands (see Figure 7).



Figure 7

6. Tilt ATTO toward the rod until the front wheel touches the ground (see Figure 8).



Figure 8

- Using the main handle, pull the main body away from the rod, thus rolling the back wheels away from the front wheel (see Figure 9).



Figure 9

- Gently move the handle down until ATTO is flat as shown in Figure 9 (see Figure 10).



Figure 10

- Place handle in the designated recess until it clicks and locks in place (see Figure 11).



Figure 11

- Lock the rod in upright position by pushing the front lever down until it clicks and locks in place (see Figure 12). . In case the front lever require too much force to operate, you should apply horizontal pressure on the main handle towards the front of the scooter. This will release the pressure on the front lever and will make it easier to open.

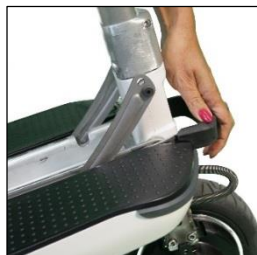

Figure 12

11. Place one hand on the tiller and with the other hand release the secure lever of the back handle and bring the handle to upright position at 90 degrees (see Figure 13).



Figure 13

Using the handle, pull the back of the chair backwards until it clicks and locks in place (see Figure 14).



Figure 14

12. Continue using the handle for pulling up the chair until it clicks and locks in place (see Figure 15).



Figure 15

13. Open both sides of the handle bar (see Figure 17).



Figure 16

Adjusting for maximum comfort

Several adjustments can be made for maximum comfort. Some adjustments can be made by the user, while other adjustments **must only be made by a certified technician**. The adjustments that can be made by the user are detailed in this section.

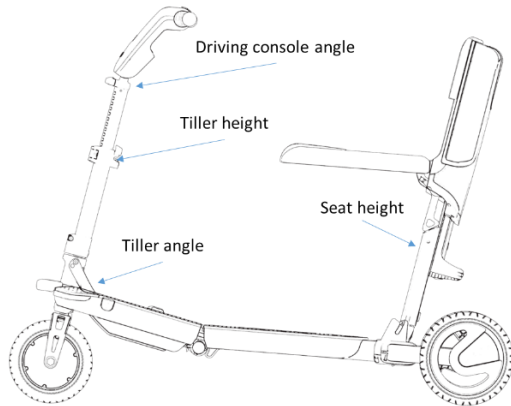

Figure 17 Comfort adjustments

Adjusting Driving Console height

Use the rod lever to adjust the height of the handle bar at your convenience. Bring the lever back to the secure position once you are done (see Figure 17).

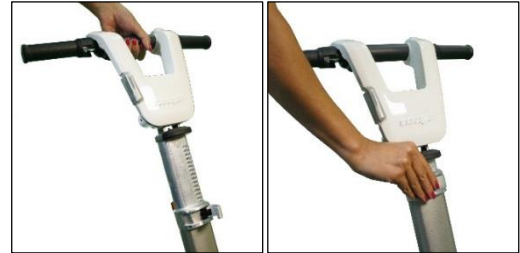

Figure 18 Driving Console height lever

Adjusting Driving Console angle

ATTO's Driving Console can be adjusted to your comfort in a variety of angles. To adjust the Driving Console you should first be seated on your mobility scooter:

1. Hold the Driving Console in one hand and release the adjusting lever using the other hand (see Figure 19).
2. Adjust the Driving Console angle so you can reach and hold it comfortably with a clear view of the display area.
3. Tighten the adjustment lever when you are done.



Figure 19 Driving Console tilt lever

Seat height adjustment

Although ATTO's seat is thin and stylish, it was designed to provide comfort and safety and can be adjusted according to user's preferences. The seat mechanism can be locked at one of three fixed heights. To adjust

seat height please follow the following steps, no tools needed:

1. ATTO has to be in opened position in order to adjust seat height. Lift the seat to upright position, locate the seat height adjustment cover at the seat base right under the seat pivots and remove it (see Figure 20).

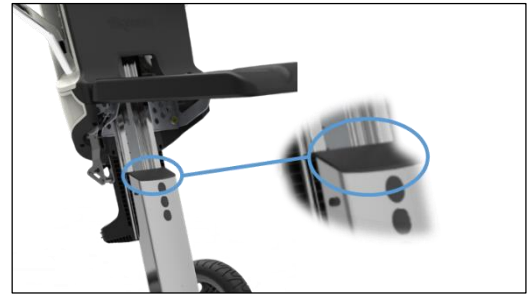

2. Figure 20 Seat height cover

3. Under the cover you will find a metal bracket that has to be removed. Hold the bracket between your fingers and lift it out. Remember the bracket

position to make it easier to put it back in place again.

4. Once the bracket has been removed you should be able to remove the bulky metal pin (located in one of the three adjustment holes) holding the seat in its place. Remove the pin while holding the seat with your other hand (see Figure 21).

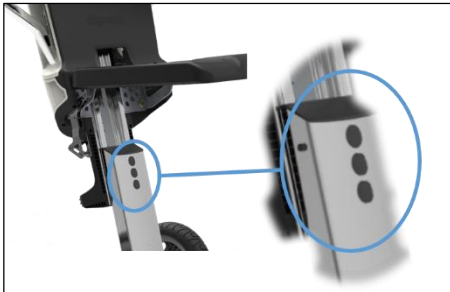

5. Figure 21 Seat height adjustment holes

6. Now you can adjust the seat to any of the three holes height and reinsert the pin to hold it in place.
7. Reinsert the metal bracket and the cover.

Tiller angle adjustment

The Steering Rod (tiller) angle can be adjusted in one of two positions according to user comfort. The default position will be adequate for most users, larger users may want the Steering Rod further away from their body for more space. In order to adjust the angle you need a 4 mm Allen wrench (hex key).

1. ATTO has to be in the opened position in order to adjust the tiller angle. Once opened, locate and release the two Alan (hex) screws shown in Figure 22 while holding the tiller in upright position (you need to hold the tiller to prevent it from falling while releasing the screws).
2. Move the tiller into the desired position and tighten the two screws back again using a thread locker (such as Loctite).



Figure 22 Steering Rod angle adjustment screws

Driving Console

The Driving Console (your scooter's dashboard) contains all the controls and display needed for operating your mobility scooter while driving.

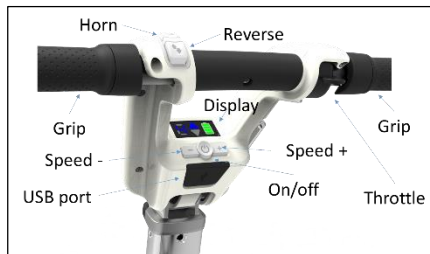

Figure 23 Driving Console overview

ON/OFF and speed control buttons

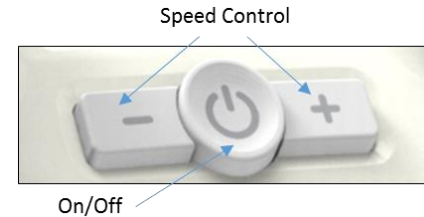

Figure 24 On/Off and speed control

- A. The On/Off button is located at the center of the Driving Console below the display panel. To turn ATTO on press and hold the button until ATTO starts.
- B. The two buttons on the sides of the ON/OFF switch marked with "+" and "-" are your speed limit control. Along with the number shown on the display panel, they allow you to set the maximum speed ATTO will develop at full throttle. While ATTO is not moving, Click the

"+" button to increase the speed and the "-" button to decrease the speed.

Display panel

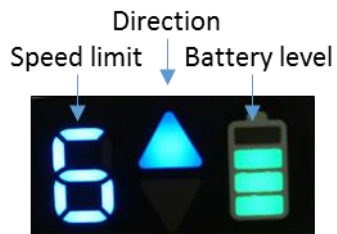

Figure 25 Display Panel

Battery meter – When ATTO power is ON the battery meter indicates the approximate battery charge level. As with all Li-ion batteries, the charge level indication is accurate only when the battery is fully charged. All other indications are approximate and intended to give you a rough idea of the battery charge level. Please refer to the "Specification" chapter in this Owner's Manual for more information on your battery range.

Direction mode – ATTO can drive both forward and backward. The current driving direction is shown on the display panel by an arrow pointing forward or backward, depending on user's selection. To switch the driving direction press on the direction button located near the left hand grip.

Throttle



Figure 26 Driving Throttle

The throttle is used for driving and controlling the driving speed. Place your thumb on the throttle lever and press it down to accelerate. To decelerate, release the throttle lever to your level of comfort. To bring the scooter to a complete stop simply remove your thumb

from the lever which will set the lever to its "off" position, bringing the scooter to a halt after 1.2 meter.

Reverse and horn buttons



Figure 27 Reverse and horn buttons

- A. ATTO is equipped with a driving direction button. Press on the button to change the driving direction. Once the driving direction has changed, ATTO will sound a single beep when in forward driving mode, and a double beep when in reverse driving mode. In addition, a large arrow on the display panel will indicate the current driving mode. When ATTO is turned on it is always in Forward driving mode.

- B. Press the horn button to sound the horn. Always use the horn when needed to prevent accident or injury.

USB port

ATTO is equipped with a general USB charging port providing up to 1.2A charging current. If an error occurred, the port is disabled and the scooter will operate as normal. The error will be reset after restarting of the scooter's controller (power off/on cycle).

Display Dimming

Pressing the '+' and '-' buttons simultaneously will toggle the dimming option.

Bee sounds

Beeps caused by pressing buttons may be enabled or disabled. To Enable, press the '+' and 'Horn' buttons simultaneously. To Mute the beeps, press the '-' and 'Horn' buttons simultaneously (horn is always active).

Handle bar grips

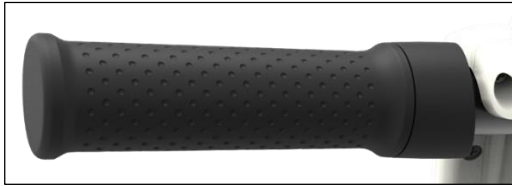

Figure 28 Handlebar grip

There are two grips on the handlebar, one on each side.

To change the grips from folded position to drive position simply lift the grip around its pivot and it will lock itself in the open position. To fold it back again (only when you are about to fold ATTO), simply pull the grip away from the handlebar and down to an angle of nearly 90 degrees where it will automatically lock itself in the new position.

Getting on ATTO

- Verify that the scooter is turned off.

- Verify that the scooter is fully opened and secured. See the "Opening" section of this Owner's Manual.
- Carefully place one foot on the approximate center of the deck and seat yourself comfortably and securely on the seat.

Getting off ATTO

- Verify that the power is turned off.
- Carefully place one foot on the ground, transfer your weight to that leg, and slowly come to a standing position.
- Step away from the scooter.

Driving

Turning ATTO on

Press and hold the "On" button to turn ATTO on. All lights will come on momentarily and then the following information will be indicated:

- Set maximum speed
- Forward driving direction (default)
- Battery charge level status

See Figure 29 Typical display after turning on.



Figure 29 Typical display after turning on

- We recommend that you select a maximum speed setting (using the "+" and "-" buttons near the On/Off switch) at which you feel comfortable, safe, and in control of your scooter.
- Make sure that you are seated safely and properly on your ATTO.

- For your first driving sessions, make sure that your ATTO starts out on a level surface and that you will continue driving on a level surface.

Forward driving

- Place your hands on the handgrips. Move the tiller to the center position to drive straight forward.
- Make sure you are in forward drive mode by looking at the Direction Arrow on the display. If the arrow points forward (away from your body to the front) then you are in Forward Mode. If the arrow points backwards in the direction of your body than you should click the Direction Button until you hear one beep and making sure the Direction Arrow is pointing forward.
- Use your right thumb to operate the drive throttle. Press the throttle lightly to move forward.
- Increase the pressure applied by your thumb to increase your speed.
- To stop ATTO, release all pressure on the throttle. The throttle will automatically return to the upper (off) position and your scooter will come to a

gradual stop. Note: Always bring your ATTO to a full stop before changing direction from forward to reverse, or from reverse to forward.

Reverse driving

- Place your hands on the handgrips.
- Use one of your left fingers to press the direction button located on the left side of the Driving Console.
- You should hear a double beep confirming you are now driving backwards. If you hear a single beep you are in forward drive mode and should click the direction button again.
- Use your right thumb to operate the drive throttle. Press the throttle lightly to move backwards.
- Increase the pressure applied by your thumb to increase your reverse speed.
- To stop ATTO, release all pressure on the throttle. The throttle will automatically return to the upper (off) position and your scooter will come to a gradual stop.

- You should know that for safety reasons ATTO's speed in reverse is slower than the maximum speed set on the speed control dial.

Stopping

Just let go of the drive throttle, which will automatically return to the upper (off). The scooter automatically brakes using the regenerative brake. This will be followed by entering the scooter into "parking" mode using the electro-mechanical brake.

Emergency braking

In case you must stop and you have released the drive throttle but your scooter continues to move, press the On/Off switch until the scooter turns off and stops.

Steering

- Steering your ATTO is easy and intuitive.

- With both hands on the handgrips of the tiller, turn the tiller to the right or to the left to change the moving direction accordingly.
- Make certain to maintain sufficient clearance when turning your scooter so that the rear wheels will clear any obstacle.

Steering in a tight spot

If you must steer in a tight spot, such as entering a doorway or when turning around:

- Bring your ATTO to a full stop.
- Turn the speed control to the slowest speed setting.
- Turn the tiller to the direction in which you wish to drive.
- Press gently on the thumb throttle and slowly turn your ATTO.

Steering in Reverse

Backing up your ATTO requires special attention to what you are doing:

- Use a left finger to click the direction button. You should hear a double beep confirming you are now driving backwards.
- Turn the tiller in the direction in which you wish to drive backwards.
- Note that for safety reasons ATTO's speed in reverse is slower than the maximum speed set on the speed control dial.

Driving on slopes

More and more buildings have ramps with specified degrees of inclination, designed for easy and safe access. Some ramps may have switchbacks (180 degrees turns) that require you to have good cornering skills on your ATTO.

- Proceed with extreme caution as you approach the downgrade of a ramp or other incline.
- Take wide swings with your ATTO around any tight corners. If you do that, the scooter's rear wheels will follow a wide arc, not cut the corner short, and

not bump into or get hung up on any railing corners.

- When driving down a ramp, keep ATTO's speed set to the slowest speed setting to ensure a safely controlled descent.
- Avoid sudden stops and starts.

When climbing an incline, try to keep ATTO moving. If you must stop, start up again slowly, and then accelerate cautiously. When driving down an incline, do so by adjustment the speed to the slowest setting and driving in the forward direction only. If your scooter starts to move down the incline faster than you anticipated or desired, allow it to come to a complete stop by releasing the throttle. Then push the throttle forward slightly to ensure a safely controlled descent.

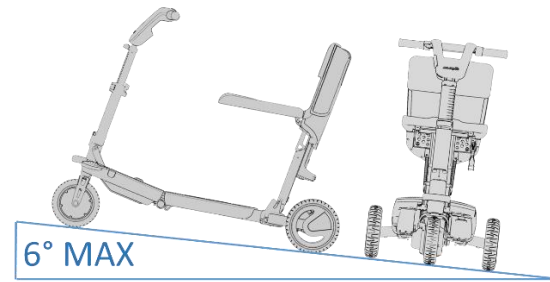

Figure 30 Maximum recommended incline angle

When you approach an incline, it is best to lean forward (see Figure 31 and Figure 32). This shifts the center of gravity of you and your scooter toward the front of the scooter for improved stability.



Figure 31 Normal driving position



Figure 32 Shifts center of gravity

Turning corners

Turning at high speed may cause a tipping over. Factors affecting the possibility of tipping over include turning speed, steering angle (how sharply you are turning the steering tiller), uneven road surfaces, inclined road surfaces, a transition from low grip area to high grip area (as moving from a grass surface to a paved surface - especially at high speed while turning), and abrupt changes of direction. High speed turning is not recommended. If you feel you are about to tip over while turning, reduce speed and steering angle (i.e., make the turn wider) to prevent your scooter from tipping over.

Folding (closing)

1. Make sure ATTO is on flat ground before folding it.
2. Fold both sides of the handle bar (see Figure 33).



Figure 33

3. Release the secure lever of the back handle and bring the handle to 90 degrees position. Allow the seat to slide down until it clicks in place (see Figure 34 & Figure 35).



Figure 34



Figure 35

4. Push the back of the chair forwards until it clicks (see Figure 36).

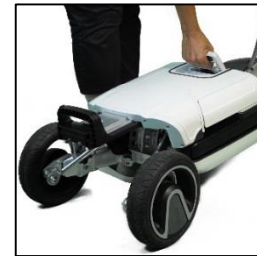

Figure 36

5. Use one hand to keep the rod upright. Using your other hand, release the front lever (see Figure 37).

In case the front lever require too much force to operate, you should apply horizontal pressure on the main handle towards the front of the scooter. This will release the pressure on the front lever and will make it easier to open.



Figure 37

Switch hands. Use one hand to keep the rod upright and use your other hand to lift the main handle (see Figure 38).



Figure 38

6. Using the main handle pull the center upwards and towards the rod until it clicks and locks in place (see Figure 39).

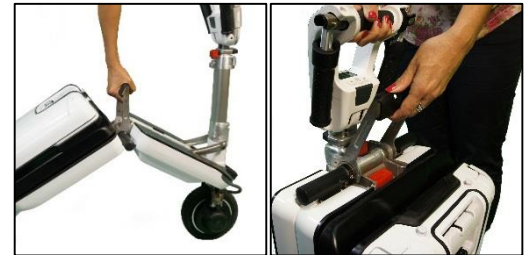

Figure 39

7. Use the rod lever to adjust the height of the handle bar to the lowest position and bring the lever back to the secure position (see Figure 40).



Figure 40

8. Release the adjustment lever of the handle bar and bring the handle bar to a horizontal position. Then bring the lever back to secure position (see Figure 41).



Figure 41

Separating the chassis

ATTO's front and rear halves (chassis) can be easily and effortlessly separated in only a few seconds by operating a knob and two handles. The same technique applies to putting the two halves back together. This is very useful when storing ATTO in the trunk or in an airplane's overhead bins.

1. Make sure the handle bar is secured at an upright position (see Figure 42).



Figure 42

2. Open both separation levers (see Figure 43). In case the separation levers require too much force to operate, you should apply horizontal pressure on the driving console towards the center of the scooter. This will release the pressure on the separation levers and will make them easier to open.



Figure 43

3. Hold the handle bar with one hand and press the central release button with the second hand until it clicks (see Figure 44).



Figure 44

4. Carry the front chassis from the handle bar and separate from the back chassis (see Figure 45).

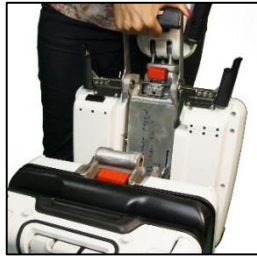

Figure 45

Lifting separated chassis

1. Once the two chassis has been separated and you are ready to lift them, for instance into your car trunk, make sure both chassis is set flat on the ground where it will not be an obstacles to you or to others,
2. Grab the one of the chassis from designated handles and carry it to its destination (see Figure 46):

- (1) Front handle
- (2) Driving console handle
- (3) Frame (underneath)
- (4) Support leg

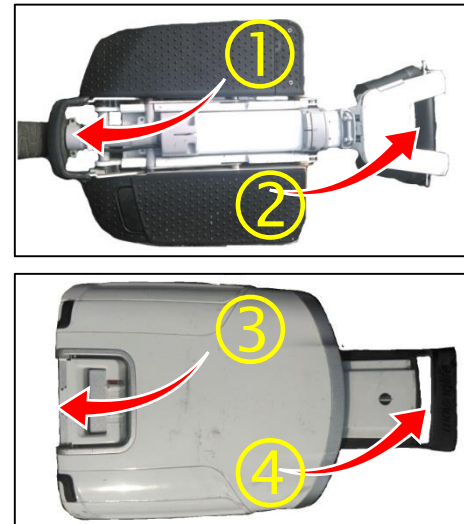

Figure 46 – lifting points

3. Repeat the previous step on the other chassis.
4. Lay the chassis flat and secure them with straps (or other ways) to insure safety and damage free transportation.

Connecting the chassis

1. Make sure the handle bar is secured at an upright position (see Figure 47).



Figure 47

Place the back chassis vertically. Hold the front chassis from the handle bar and bring it towards the back chassis (see Figure 48).



Figure 48

2. Bring the two parts together. Use the hanging hooks (see Figure 49) to locate the two ends properly. At this point the central release button will click.



Figure 49

3. Close the two separation levers until they click (see Figure 50). In case the separation levers require too much force to operate, you should apply horizontal pressure on the driving console handle towards the center of the scooter. This will release the pressure on the separation levers and will make them easier to open.

NOTE: DO NOT try to open ATTO for driving before the two levers are secured in the downwards position



Figure 50

Freewheel

ATTO is equipped with a manual freewheel lever, which when pushed to “N” state it in freewheel mode and allows the scooter to be pushed.

- Change to freewheel mode only on a level surface.
- Ensure ATTO's power is turned off.
- Never sit on ATTO while handling the freewheel lever.

Operating the freewheel

In case the battery dies or ATTO is not driving, ATTO may be rolled manually. This will require releasing the mechanic auto-brake of the front wheel using the free wheel lever (see Figure 51).



Figure 51 Releasing the freewheel

Before driving ATTO again, make sure the freewheel lever is pushed backwards (see Figure 52).



Figure 52 Securing the freewheel

Battery and charger

ATTO's charger is a small yet smart and powerful charger with the ability to connect to any electrical grid rating 110VAC – 240VAC. It is fully approved and safe to use.

- When connecting the charger, connect the DC charging cord to the battery charge plug before connecting the charger AC cord to the electrical outlet.
- When disconnecting the charger, always do so in reverse order of the connecting procedure.



Figure 53 ATTO's Li-ion Battery



Figure 54 ATTO's Charger

Installing the battery

To install the battery, insert first the back end of the battery and then push the front until the battery clicks and locks in place (see Figure 55).



Figure 55

Removing the battery

Identify the battery release button highlighted in red frame in Figure 56.



Figure 56 - battery release button

To remove the battery from ATTO, press the release button and pull the battery out (see Figure 57).



Figure 57

Use the handle for carrying the battery when removed from ATTO (see Figure 58).



Figure 58

Charging the battery can be done on board and off board, meaning you can connect the charger when the battery is in its place inside ATTO or when it is taken out of ATTO.

Charging the battery

1. Connect the charger to the electric socket. The Green LED should turn green to indicate the charger is properly connected to the socket.
2. Connect the other end of the charger to ATTO's battery. The charger LED will turn red to indicate the battery is not fully charge and that charging is taking place.
3. When the battery is fully charged, the LED will turn green. This may take up to 6 hours. Once charging is complete, disconnect the charger from the wall socket and then disconnect the battery from the charger.

TRANSPORTING ATTO

ATTO can be effortlessly transported in many types of vehicles, on land, sea or by air.

Transport of ATTO on commercial aircraft is subject to federal regulations and airline policy. Please consult your airline prior to your flight to ensure your ATTO and its lithium-ion battery is permitted.

To transport ATTO:

- ◆ For safety reasons, remove the battery and place it in a safe location.
- ◆ Make sure it is fully closed.
- ◆ To prevent injury and damage, secure ATTO in a way that will prevent it from moving around or shaking.
- ◆ Cover or otherwise secure the tiller and handlebar to prevent it from being damaged due to moving

objects or by ATTO shifting around during transport.

To transport ATTO in a car please see the “Separating the chassis” chapter in this Owner’s Manual.

SPECIFICATIONS

Model

ATTO Mobility Scooter Type I

Speed

ATTO's maximum speed (limited by software) is 6.4 km/h (4 mph). Maximum driving speed can be set to one of the presets by simply clicking a button and watching the indication on ATTO's clear view display.

Weight

| Part | Kg | Lbs |
|-------------|------|------|
| Front half | 12 | 26.4 |
| Rear half | 16.2 | 35.7 |
| Assembled * | 28.2 | 62.2 |
| Battery | 1.85 | 4.1 |

* Without the battery

Weight Capacity

Maximum user weight is 100 Kg (220 Lbs).

Dimensions

When folded, ATTO is the most compact mobility scooter in the world. Nevertheless, when open and ready to drive, ATTO is the largest and most comfortable in its category.

ATTO's dimensions, units in cm (inch):

| Part | Height | Length | Width |
|--------------|---------|-----------|-----------|
| Trolley mode | 72 (28) | 39 (15.3) | 42 (16.5) |
| Drive mode | 90 (35) | 120 (47) | 56 (22) |

Ground clearance

ATTO's minimum ground clearance is 10 cm (4").

Front wheel drive motor

To allow smooth and continuous drive over many years and large distances, we developed a unique, fully customized, brushless, permanent magnet DC motor, combining solid core and powerful gear along with robust braking mechanism. Via sophisticated software algorithms the motor utilizes modern reverse charging techniques for deceleration and stopping providing smooth driving experience.

Tires

PU filled non-pneumatic tires.

Battery

ATTO uses a powerful, yet compact, lightweight advanced 48 Volts lithium-Ion battery. Weighing only 2 kg (4.4 lbs), the battery allows for more than 16 km (10 miles) of continuous driving while requiring only 4 hours (on average) to fully charge. You can charge ATTO on-board and off-board, meaning that you can (but do not have to), take the battery off the scooter in order to

charge it. Removing the battery is as easy as pressing a button. Reinstalling the battery is as easy as putting it back in place.

Operating range

| Battery model | Metric | Imperial |
|---------------|--------|----------|
| 125 W/h | 8 Km | 5 Mile |
| 250 W/h | 16 Km | 10 Mile |
| 375 W/h | 25 Km | 16 Mile |

Charger

UL and CE approved Charger with self-shutdown functionality for safety and extended battery and charger lifetime.

Controller

Unique Brushless DC Motor Controller. Genuine product by Moving Life Ltd. Unique LED Display with options of Dimming and a clear error display. Internal data and error log for easy maintenance and

traceability. Moving Life Controller provide 10A continues working current with maximum of 30A peak.

Turning Radius

1.35 meters (53”).

Freewheel mode

Yes.

Maximum incline

6 degrees.

Height Restrictions

Preliminary tests show that a minimum height of 150 cm (5 Feet) is required for safe driving. This is NOT a formal recommendation, we have not concluded the tests yet, and you should check with your medical advisor.

Environment

ATTO was designed and tested according to strict water resistance IP54 standard, requiring the equipment to be water resistant to splash from multiple angles, for a long period of time and at high pressure. After taking a 50 liters shower ATTO continued to work with zero malfunctions, which guarantees resistance to normal outdoor conditions. Nevertheless, we recommend storing ATTO indoor to ensure maximal lifetime of high performance and for safety reasons use it only under dry weather conditions.

Flammability

ATTO Is designed according to UL94 V-0.

Responsibility of the Manufacturer

The manufacturer considers itself responsible for the effects on safety, reliability, and performance of the equipment only if:

- Calibration, service and repairs of the ATTO Mobility Scooter are carried out by Moving Life Ltd personnel, or anyone authorized by Moving Life Ltd.
- The equipment is used in accordance with instructions for use.

ATTO Owner's Manual
English



(RG021)

RG-021-ATTO 1 OWNERS MANUAL SHORT VERSION Ver 1.0.docx
DO NOT USE THIS DOCUMENT AS OWNER'S MANUAL

Copyright © 2015
All rights reserved